

Cooke Dam



Cooke Dam



River Hydro Asset Key Terms

Definitions/purpose of the major components and aspects critical of safe, compliant, and reliable operations:

- **Dam:** The entire barrier to hold back the water (reservoir) typically consists of embankments, spillways, and powerhouse
- **Spillway:** Primary location for water flow when not used for generation
- **Powerhouse:** Location of generation units
- **Embankment:** Earthen barrier to hold back the reservoir, which contains a hydraulic barrier (core wall)



Cooke Dam Structures



Original Survey Drawings for Cooke Dam

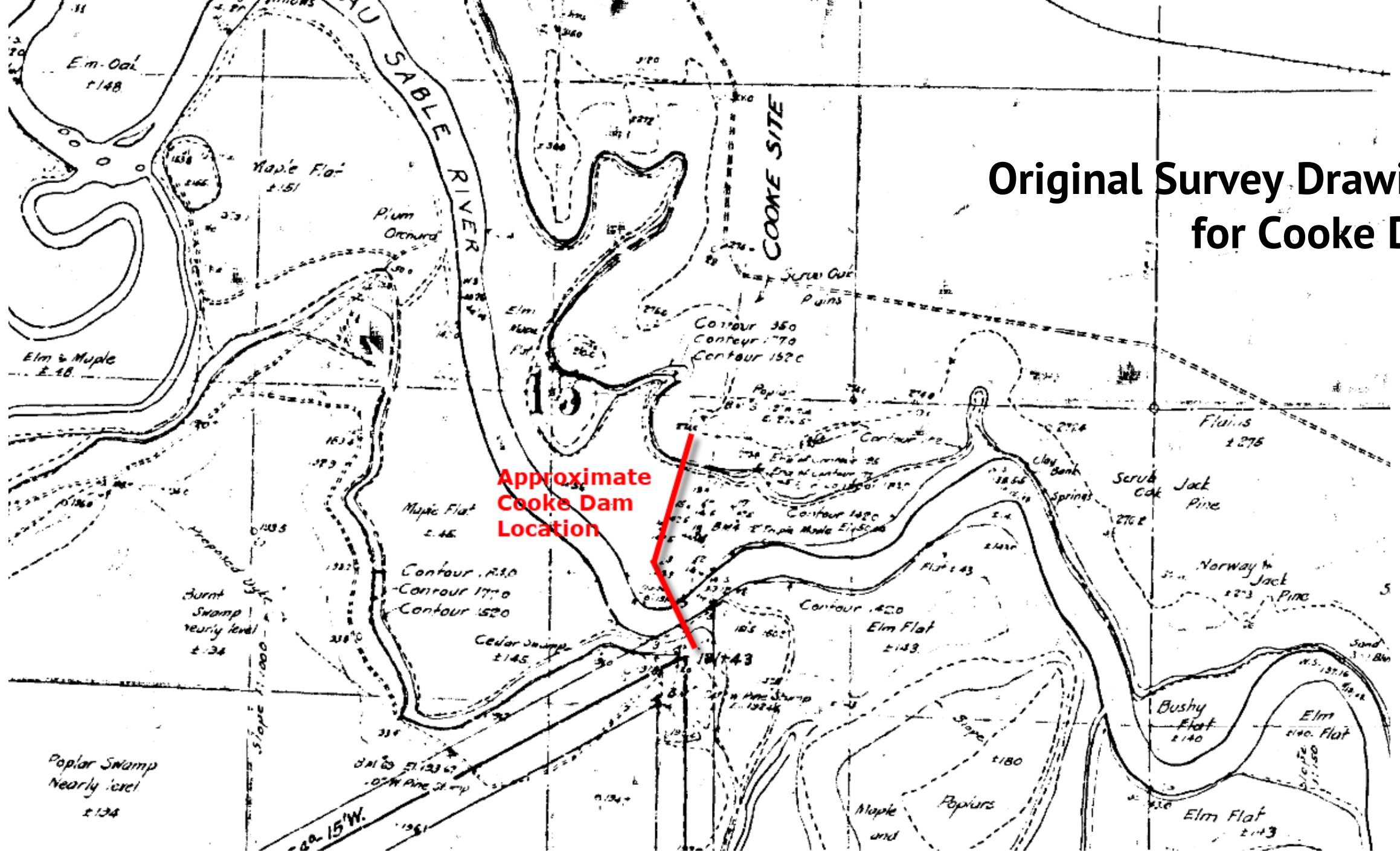

Cooke Hydro

- With a capacity of 9,000 kilowatts, the hydro began generating electricity in December 1911.
- Cooke was listed in the National Register of Historic Places on August 2, 1996.
- The honor recognizes the hydro's transmission of 140,000 volts, 125 miles to Flint, establishing a world record.
- Lumberman's Monument, a 14-foot bronze statue dedicated to Michigan lumbermen, is the centerpiece of a major Forest Service Visitor Center located on the Cooke Hydro pond

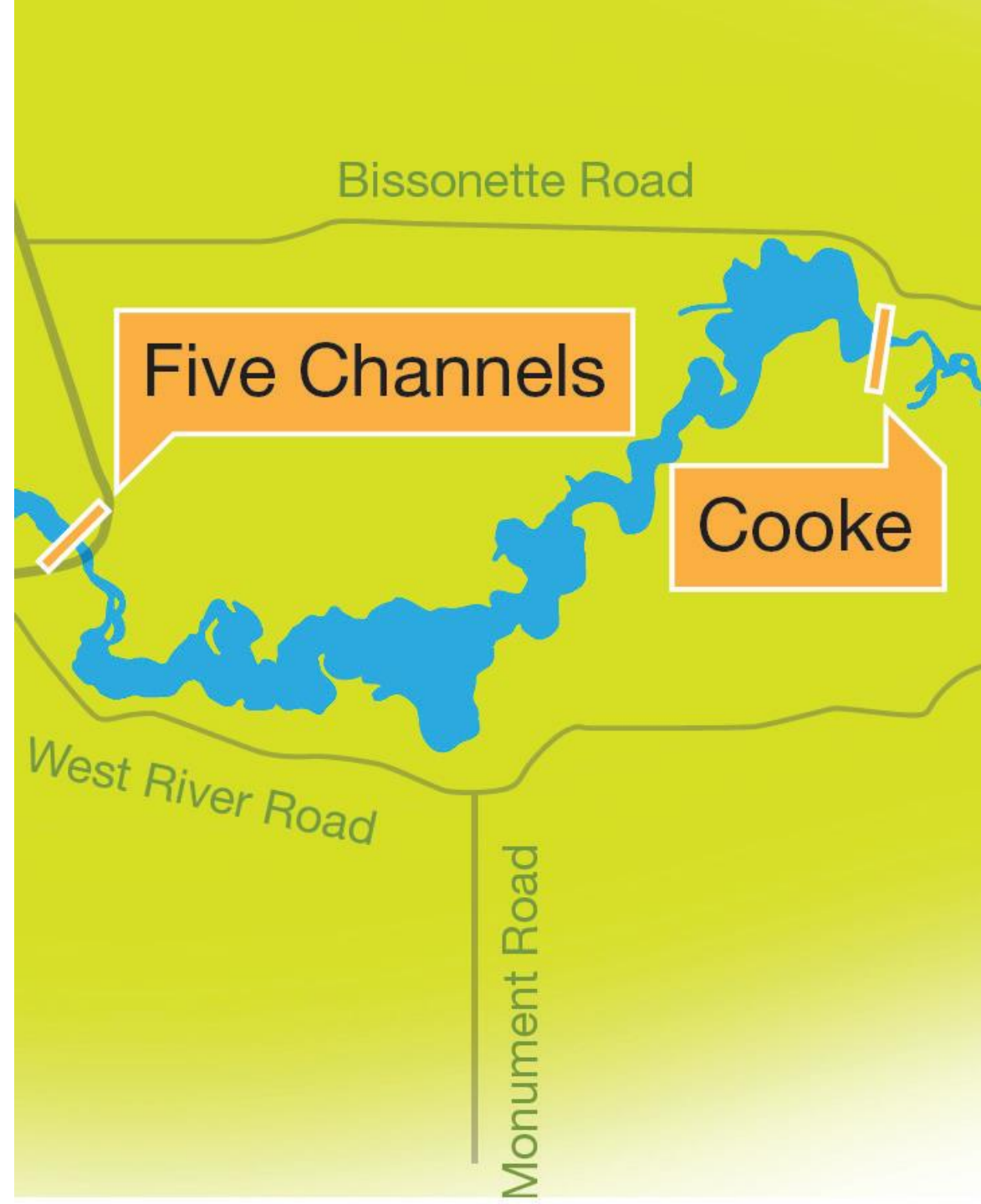

General Information: Cooke Dam

FERC License Expiration Date: June 30, 2034

Dam Height (ft.): 50

Length of Dam (ft.): 900

Drainage Area (sq. miles): 1,641

Impoundment Area (acres): 1,700

Age (years): 111

FERC Hazard Classification: High*

Approximate Population at Risk: 600

Approximate Recreation Use:

- 103,000 visitors annually
- 22 boat docks
- 77 campsites

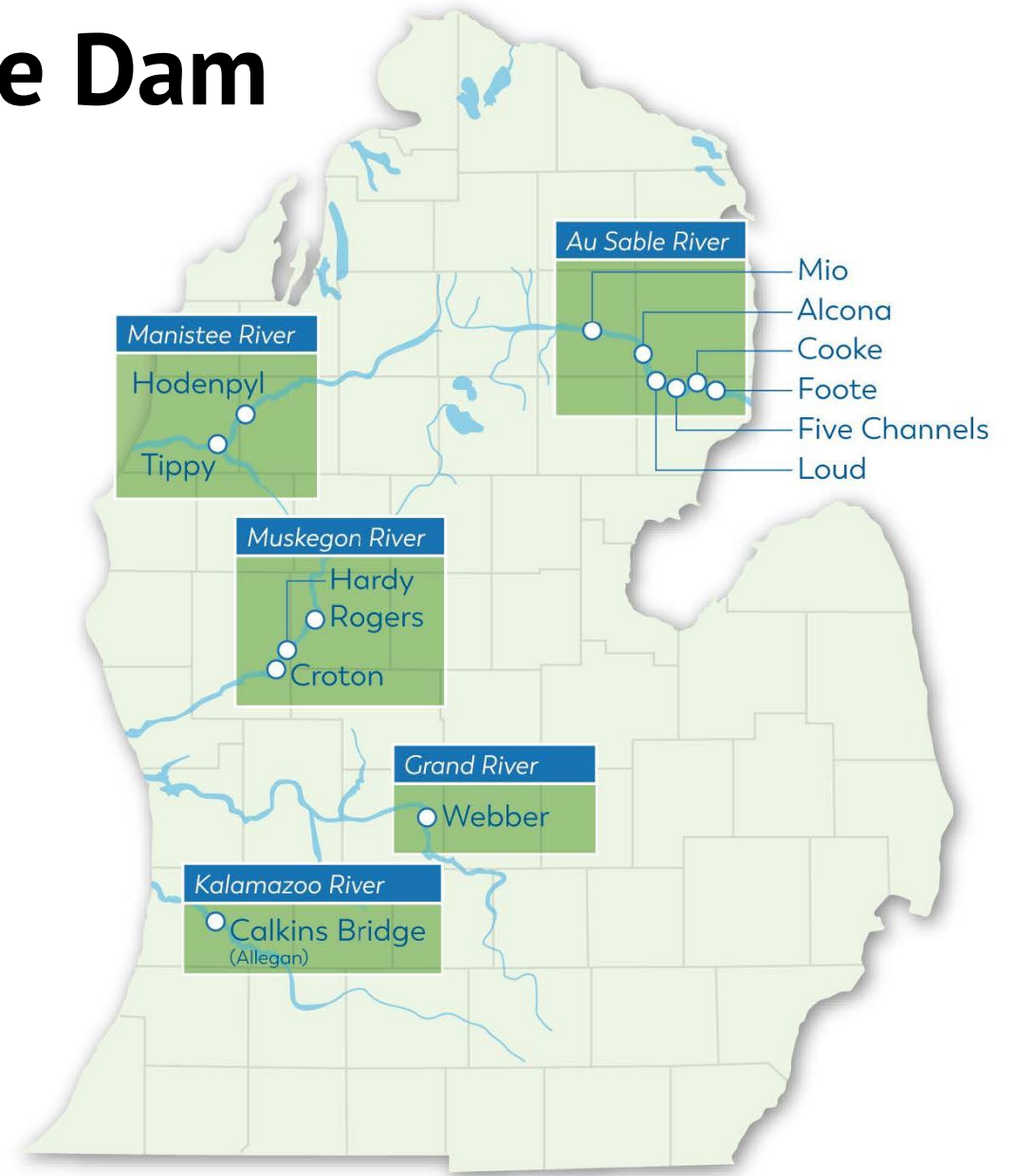

**Failure or misoperation will probably result in loss of human life.*

Percentage of Fuel Type Used to Produce Consumers Energy's Total Electricity

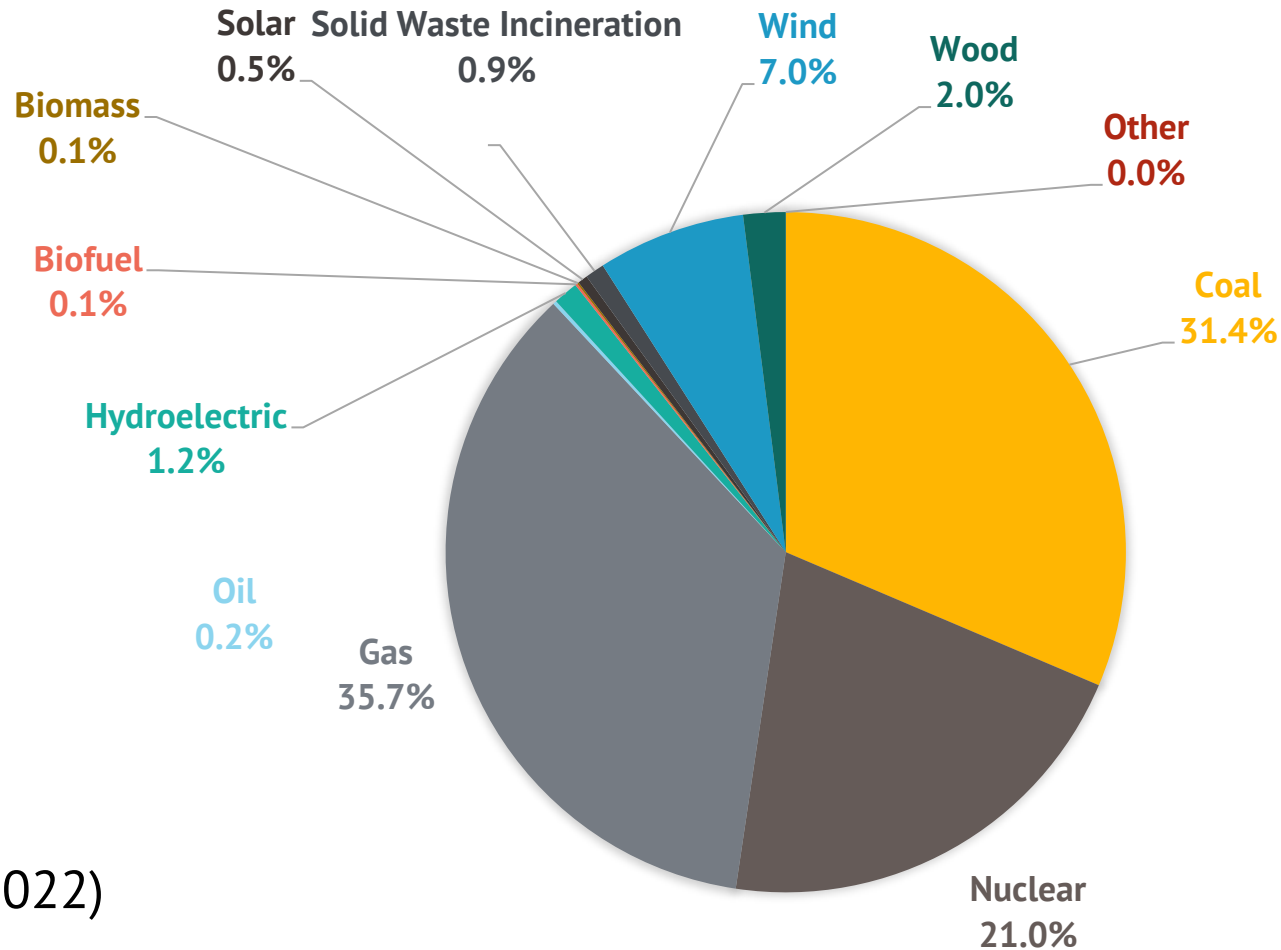

(Apr 2021-Mar 2022)